

PermaTherm

Insulation Innovation

269 Industrial Park Rd.
Monticello, GA 31064
{p} (706) 468-7500
{f} (706) 468-7510
{e} info@permatherm.net

PermaCast Factory Fabricated Insulated Roof and Wall Sleeves

PermaTherm's roof and wall sleeves are pre-assembled to improve installation time. In addition, they help to establish the proper hole diameter to cut in the roof deck.

Supplied in lengths up to 120", the pre-assembled insulation sleeves are designed for temperatures of -310° to 1200° Fahrenheit.

Contact PermaTherm's sales representative for pricing and product availability.

Approved by Carlisle Synthec, Inc. and Firestone, the two leading manufacturers of EPDM roofing material.

Why use PermaTherm's PermaCast™ Roof and Wall Sleeves?

- v Establishes correct hole diameter in deck and wall for pipe and insulation.
- v Fast installation for existing cooler and freezer buildings. Dry-in time in minutes. Less call-backs.
- v Less time coordinating different crafts. Normally three crafts are required to make cooler and freezer penetrations.
- v Quality penetrations for an economical price.

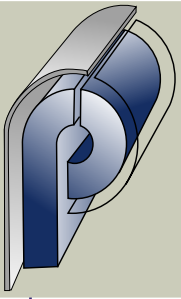

PermaTherm

Insulation Innovation

269 Industrial Park Rd.
Monticello, GA 31064
{p} (706) 468-7500
{f} (706) 468-7510
{e} info@permatherm.net

PermaCast®

Factory Applied Monolithic Vapor Barrier Coating

PermaCast® is an elastomer vapor barrier and weatherproof coating designed for the protection of PermaTherm's Insulation Products. PermaCast vapor barrier coating has outstanding flexibility, in addition to its superior vapor barrier characteristics. PermaCast® was developed for chilled water, refrigerant, and cryogenic piping, fittings, valves, and vessels.

Typical Physical Properties

Water Vapor Transmission	E-96 .02
Tensile Strength (psi)	1,900
Elongation, (%)	31
Flexural Modulus (psi)	81,864 (@-20°F) 58,736 (@72°F) 4,475 (@158°F)
Tear Strength, Graves (pli)	223
Notched Izod Impact (ft.-lbs./in.)	1.23
Coef. Lin. Therm Exp (X10 (-6))	113
Heat Distortion (°F@ 66 psi)	160
Hardness (Short 'D')	67
Density (lb./ft ³)	50
Taber Wt. Loss, mg loss	518 [1000 cycles, 18 wheel]
NBS abrasion, cycle	200
NBS inches abraded to	.1 in

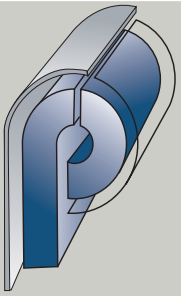

PermaTherm

Insulation Innovation

269 Industrial Park Rd.
 Monticello, GA 31064
 {p} (706) 468-7500
 {f} (706) 468-7510
 {e} info@permatherm.net

Minimum .016 Aluminum weather barrier counter flashing to extend over roof flashing, providing roof flashing is in place at time of installation. Aluminum Jacketing shall stop a minimum of 4 inches above roof membrane

Flashing to be applied in accordance with membrane manufacturer's recommendation by roofing contractor

Stainless steel band

Seal with Butyl Caulking

Minimum 2" wide MLS14 vapor barrier tape

MLS14 Vapor Barrier

Polyurethane Foam

Butyl Caulking

OUTSIDE BUILDING

Refrigeration Pipe

MLS14 Vapor barrier

Minimum 2" wide MLS14 vapor barrier tape

1/2" Stainless steel band to secure Aluminum Jacket

Permacast 70023R coating .125" thick SHORE D hardness 70

ROOF INSULATION

Minimum .020 PVC finish inside

INSIDE BUILDING

FACTORY FABRICATED ROOF SLEEVE

NOTE:

1. Insulation pipe sleeve to be installed before pipe.
2. Pipe Sleeve to be a minimum of 22 inches above metal deck.
3. Field flashing of roof penetration by others.
4. MLS14 Vapor barrier to be sealed to pipe sleeve with MLS14 tape.